

Thermostatically controllable valves

art. VD/VS/VCR/VCD/VCS xxxx

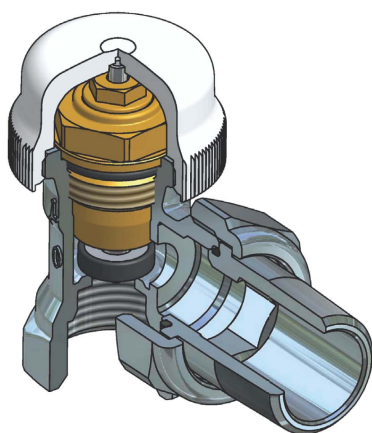

Thermostatically controllable valves have the purpose to cut-off, throttle and regulate flow rate through the heating body, since they are ready for thermostatic, electrothermal or manual head. A classic application of these valve is to equip them with a thermostatic head, so to make zones independent of each other by allowing the temperature regulation of the single room; this provides highly comfortable conditions and energy saving at the same time, as required by current local and international standards. Each valve is equipped with a protecting cover that preserves the thread, completely closes the valve during system test, and allows nominal lift calibration. The thermostatic inserts can be inspected and, if necessary, the o-ring on the spindle can be replaced, even while the system is working.

■ TECHNICAL FEATURES

Max static operating pressure: 10 bar
 Max operating temperature: 120 °C
 Max differential pressure: 1 bar

■ MATERIALS

Valve body: CW617N
 Other brass parts: CW617N
 Rubber sealing parts: peroxide EPDM
 Protecting cover: ABS
 Steel parts (spring, washer and spindle): stainless steel

DIMENSIONS

Thermostatically controllable straight valve with iron pipe connection

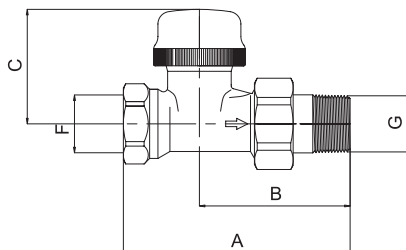

ART.	COD.	SIZE	A	B	C	F	G
VD 2101	500439	DN 10	75	51	43.5	3/8"	3/8"
VD 2101	500440	DN 15	82	55	43.6	1/2"	1/2"
VD 2101	500308	DN 20	97.5	65.5	43.7	3/4"	3/4"

Thermostatically controllable angle valve with iron pipe connection

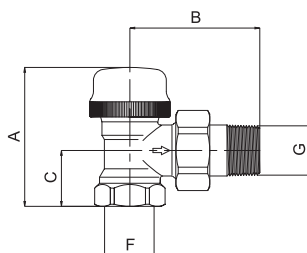

ART.	COD.	SIZE	A	B	C	F	G
VS 2102	500500	DN 10	56.5	49	20	3/8"	3/8"
VS 2102	500501	DN 15	59.5	53	23	1/2"	1/2"
VS 2102	500309	DN 20	59.5	62.5	26	3/4"	3/4"

Thermostatically controllable straight valve with copper pipe connection

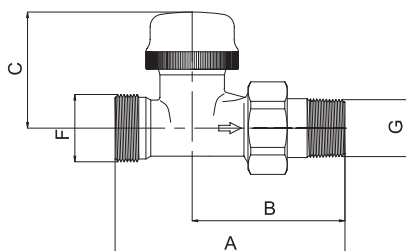

ART.	COD.	SIZE	A	B	C	F	G
VD 2103	500476	M24	82	55	43.5	M24×1.5	1/2"
VD 2105	500473	EUROKONUS	82	55	43.5	3/4"	1/2"

Thermostatically controllable angle valve with copper pipe connection

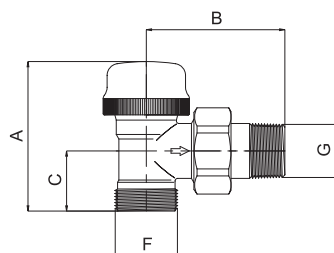

ART.	COD.	SIZE	A	B	C	F	G
VS 2104	500515	M24	59.5	53	23	M24×1.5	1/2"
VS 2106	500805	EUROKONUS	59.5	53	23	3/4	1/2"

Thermostatically controllable straight valve with iron pipe connection and angle pipe union

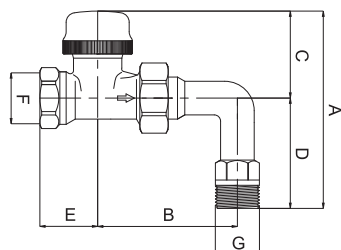

ART.	COD.	SIZE	A	B	C	D	E	F	G
VD 2111	500479	DN 15	96	66.5	43.5	52.5	27.5	1/2"	1/2"

Thermostatically controllable straight valve with copper pipe connection and angle pipe union

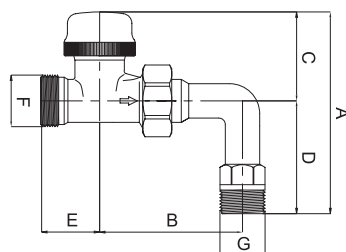

ART.	COD.	SIZE	A	B	C	D	E	F	G
VD 2113	500493	M24	96	66.5	43.5	52.5	27.5	M24×1.5	1/2"
VD 2115	500496	EUROKONUS	96	66.5	43.5	52.5	27.5	3/4	1/2"

Thermostatically controllable straight valve with no fitting and EK connection

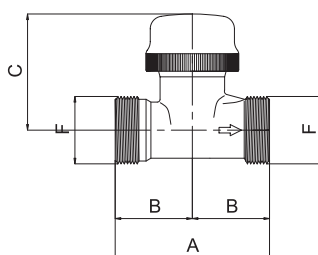

ART.	COD.	SIZE	A	B	C	F
VD 2127	500890	EUROKONUS	55	27.5	43.5	3/4"

Thermostatically controllable reverse-body valve with iron pipe connection

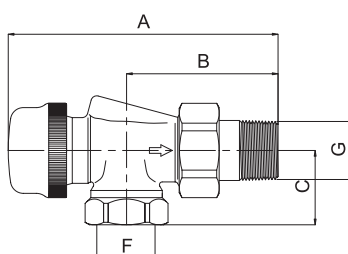

ART.	COD.	SIZE	A	B	C	F	G
VCR 2132	500399	DN 15	96.5	53.5	26	1/2"	1/2"

Thermostatically controllable reverse-body valve with copper pipe connection

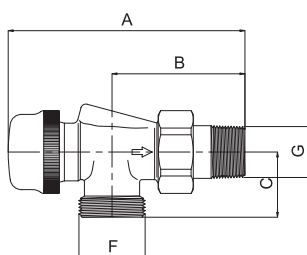

ART.	COD.	SIZE	A	B	C	F	G
VCR 2134	500300	M24	96.5	53.5	26	M24×1.5	1/2"
VCR 2136	500558	EUROKONUS	96.5	53.5	26	3/4"	1/2"

Thermostatically controllable (right or left) coaxial valve with iron pipe connection

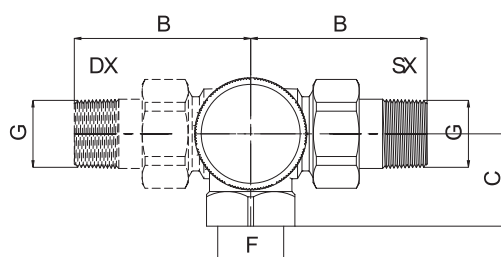

ART.	COD.	SIZE	B	C	F	G
VCD 2162 DX	500829	DN 15	53.5	27	1/2"	1/2"
VCS 2162 SX	500433	DN 15	53.5	27	1/2"	1/2"

Thermostatically controllable (right or left) coaxial valve with copper pipe connection

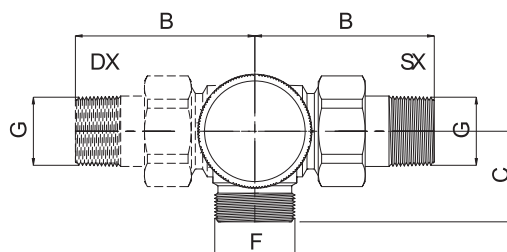

ART.	COD.	SIZE	B	C	F	G
VCD 2164 DX	500427	M24	53.5	27	M24×1.5	1/2"
VCS 2164 SX	500435	M24	53.5	27	M24×1.5	1/2"
VCD 2166 DX	500430	EUROKONUS	53.5	27	3/4"	1/2"
VCS 2166 SX	500518	EUROKONUS	53.5	27	3/4"	1/2"

HYDRAULIC FEATURES

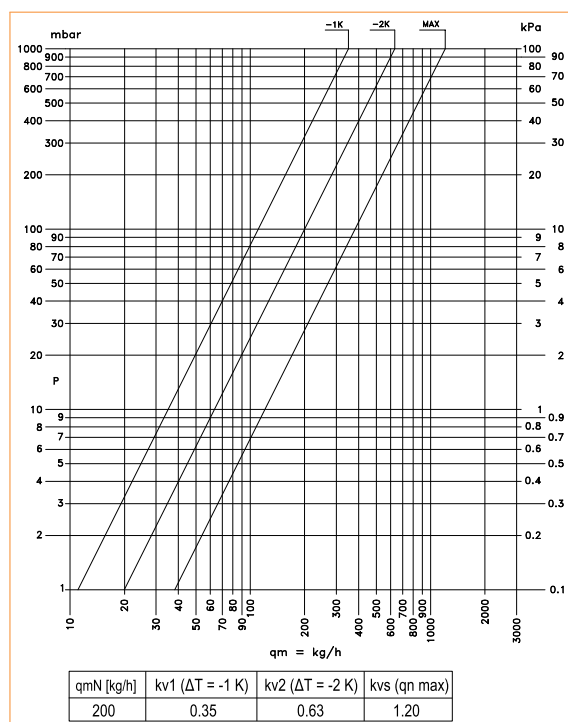

OPERATING INSTRUCTIONS

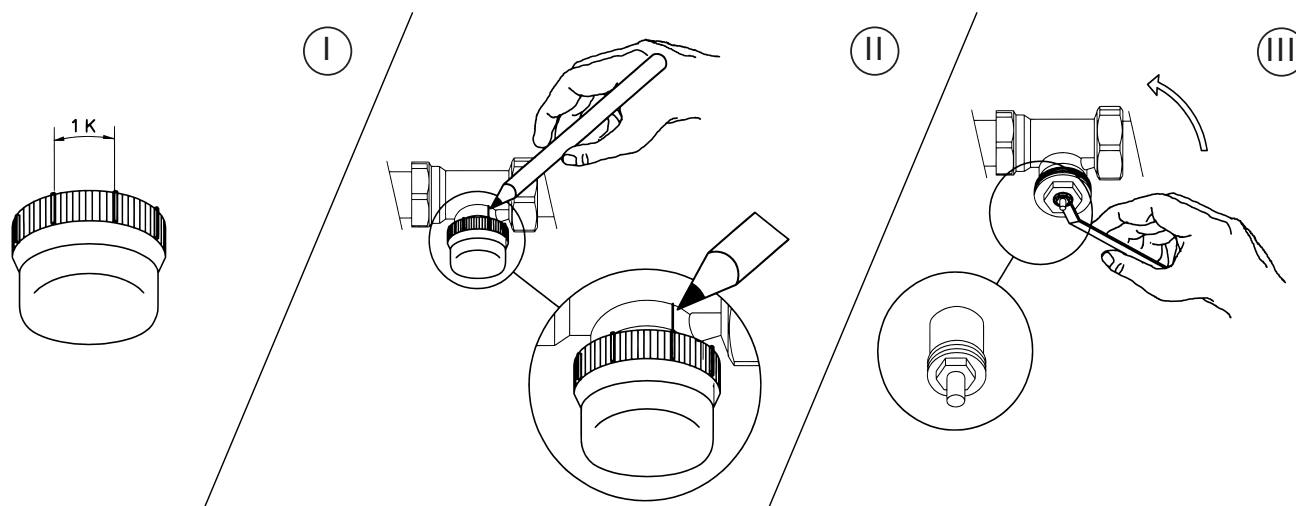

Protecting cover (Fig.I)

- Preserves thread during installation;
- Allow to completely close the valve;
- Allow calibration of nominal lift.

Calibration of nominal lift (Fig.II)

1. Screw the cover manually up to mechanical stop;
2. Draw on the valve body a reference line corresponding to one of the cover notches;

3. Unscrew the cover by 4 notches.

Spindle seal (Fig.III)

The seal system can be easily replaced without draining the plant:

1. Unscrew the hexagonal head nut (8 mm) with a spanner, and replace it, included the stainless steel spindle;
2. Mount the nut and screw tightly.

NOTES

Thermostatically controllable valves (except valves with iron pipe connections DN 10 and DN 20, and art. VD 2111, VD 2113, VD 2115 and VD 2127) are available in the following versions:

- standard → catalogue code
- with soft-seal pipe union fitting → catalogue code + suffix "RC";
- with soft-seal pipe union fitting reduced 3/8 M → catalogue code + suffix "RCR".

Example - Straight thermostatically controllable valve with iron pipe connection, size DN 15

- standard version → 500440;
- version with soft-seal pipe union fitting → 500440RC;
- version with reduced 3/8 M soft-seal pipe union fitting → 500440RCR.

CERTIFICATIONS

I.V.A.R. systems consisting of thermostatic head + valves with fixed Kv in the following are certified according to the European standard EN 215:2004/A1:2006.

	VALVE ART.	SIZE	HEAD
	VD 2101	DN 15	T 1000, T 2000, T 3000, T 4000, T 5000, DH 01 (OPTIMA white or black)
	VS 2102	DN 15	T 1000, T 2000, T 3000, T 4000, T 5000, DH 01 (OPTIMA white or black)
	VD 2101	DN 10 - DN 20	T 1000, T 2000, T 3000, T 4000, T 5000
	VS 2102	DN 10 - DN 20	T 1000, T 2000, T 3000, T 4000, T 5000
	VD 2103	M24(*)	T 1000, T 2000, T 3000, T 4000, T 5000
	VS 2104	M24(*)	T 1000, T 2000, T 3000, T 4000, T 5000
	VD 2105	EK(*)	T 1000, T 2000, T 3000, T 4000, T 5000
	VS 2106	EK(*)	T 1000, T 2000, T 3000, T 4000, T 5000

(*) The connection is not included in Annex A of EN 215:2004/A1:2006 standard

ACCESSORIES



DH 01. Thermostatic head (chrome, steel, white, black, gold or silver coloured surface).



T 3000. Thermostatic head with integrated command and sensor. Adjustment field 6.5÷28 °C.



T 5000. Thermostatic head with integrated command and sensor. Adjustment field 6.5÷28 °C.



T 1000. Thermostatic head with integrated command and sensor. Adjustment field 6.5÷27.5 °C.



T 3010. Thermostatic head with integrated command and remote wall sensor. Adjustment field 6.5÷28 °C.



T 5020. Thermostatic head with integrated command and remote wall sensor. Adjustment field 6.5÷28 °C.



TM 3052. Brass nut manual head.



TE 3040-TE 3041. Normally closed two-wire electrothermal head (230 V or 24 V).

I.V.A.R. S.p.A.
Via IV Novembre 181
25080 Prevalle (BS)
Tel. +39 030 68028
Fax +39 030 6801329
www.ivar.eu - info@ivar.eu

I.V.A.R. S.p.A. reserves the right to make enhancements and changes to products and relative documentation at any time without prior notice. All rights reserved. Reproduction, even partial, is forbidden without prior permission by the copyright owner.